

DI6735T & DI865T SERIES

Replacement Internals

REPLACES: TORO® 630, 660, 730, 760

NOZZLE INSTALLATION GUIDE

STEP 1: REMOVE DRIVE ASSEMBLY

STEP 2: INSTALL NEW NOZZLE

- Remove screws (2) on top of nozzle cap.
- Pull off nozzle cap.
- Snap in correct nozzle.
(see Performance Chart).
- To remove nozzle, pull out using snap ring tool or screwdriver.

STEP 3: INSTALL NEW CONVERSION DRIVE ASSEMBLY

- Place new assembly in body.
- Install new snap ring.
- Reinstall cap with screws (2).

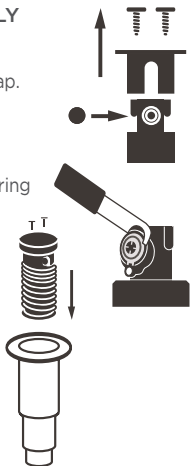

ADJUSTABLE PART CIRCLE OPERATION

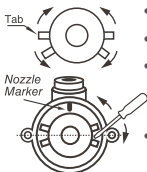

- Rotor must be OFF.
- Rotate EASY ARC Cap.
- Using a small screw driver or pointed object, move right and left tabs on each side of the Nozzle Marker. Example 180°
- Replace EASY ARC cap.

NOTE: Make sure nozzle faces area to be irrigated.

Nozzle	Base Pressure (PSI)										Toro Nozzle Reference				
	50	55	60	65	70	75	80	85	90	95	100	630	660	730	
14	Radius	52	53	54	55	56	57	58	59	59	60				
Yellow	GPM	11.0	12.0	13.0	14.0	14.5	15.0	15.5	15.9	16.3	16.6	17.0	31	-	31
16	Radius	55	56	57	58	59	59	60	61	61	62	62	62	32	32
Orange	GPM	13.3	14.1	14.9	15.7	16.3	16.9	17.5	17.8	18.1	18.4	18.7			
18	Radius	60	61	62	63	64	64	65	66	67	67	68	63	63	33
Brown	GPM	16.8	17.2	17.5	17.9	18.6	19.3	20.0	21.0	21.9	22.9	23.8			
25	Radius	62	3	64	65	66	66	67	68	70	71	72	34	-	34
Blue	GPM	21.8	22.6	23.4	24.2	24.8	25.4	16.0	27.0	28.1	29.1	30.1			
28	Radius	66	67	68	69	70	70	71	72	73	74	75	-	64	35
Green	GPM	25.0	25.8	26.6	27.4	28.1	28.8	29.5	31.0	32.5	34.0	35.5			

Shaded area represents pressure not recommended for optimal nozzle performance.